



seeTouch® guestroom solutions

Installation Guide

Please Read

230 V~ 50/60 Hz 8,75 A (40 – 350 W per zone)
24 V== 200 mA (Panels with a power supply only)

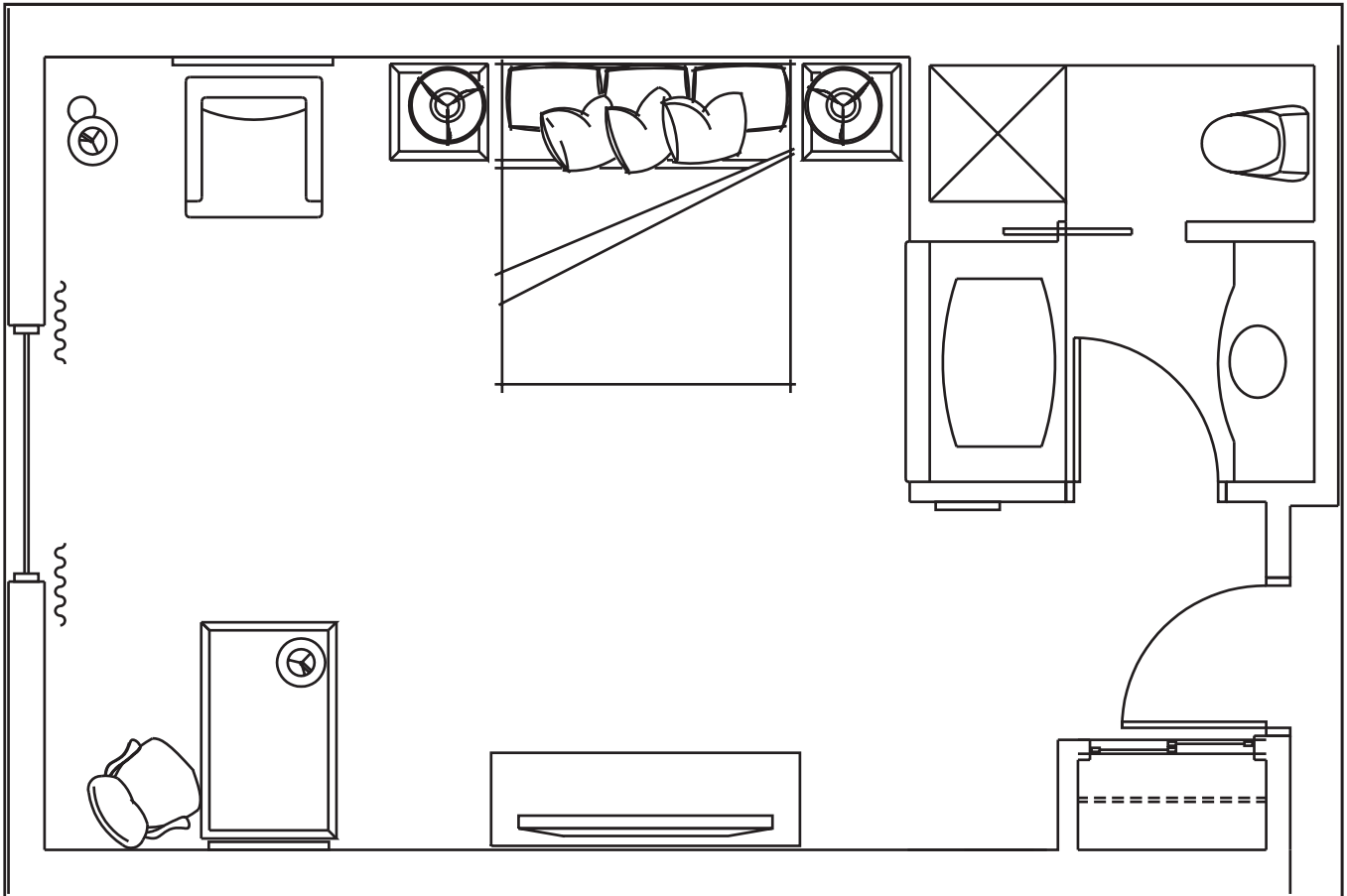

IMPORTANT:

- Lighting controls must be installed by a qualified electrician in accordance with all applicable regulations.
-  **WARNING: Shock Hazard.** May result in death or serious injury. DO NOT WIRE LIVE! Interrupt power via circuit breaker before wiring and servicing.
- Always turn off circuit breaker/MCB or remove main fuse from power line before doing any work.
- To reduce the risk of overheating and possible damage to other equipment, the module must be mounted as shown. Failure to provide adequate space for cooling may result in overheating and void the warranty.
- Module hums slightly during operation and the internal relay clicks when the circuit is turned on and off. Choose an installation location where these sounds are acceptable.
- Lighting controls are designed for commercial indoor use only.
- This control uses PELV wiring methods. Check with your local electrical inspector for compliance with national and local codes and wiring practices.



Table of Contents

Contents

| | |
|--------------------------|----|
| Overview | 3 |
| Dimensions and Mounting | 4 |
| Panel Wiring | 5 |
| Control Unit Wiring | 6 |
| Wallstation Installation | 7 |
| Start-Up Procedure | 8 |
| Ethernet Wiring | 9 |
| Contact Closure Wiring | 10 |
| Warranty | 11 |
| Contact Information | 12 |

Overview

Powered by a precision-engineered dimming panel, the new seeTouch® guestroom solution is a cost-effective, simple-to-install lighting control solution for hotel guestrooms.

Panel Details

Description

- Allows setup of lighting scenes and shade presets using buttons on the panel.
- Controls many light source types directly and others using power interfaces.
- Provides individual control of light sources.
- Includes built-in astronomic timeclock.
- Includes one contact closure input and 24 V $\overline{=}$ power for occupant sensors or other building management systems.
- Includes communication link for seamless integration of lights, motorized window treatments, and control stations.
- Compatible with all Lutron® QS system components.

Dimensions

All dimensions in mm (in)

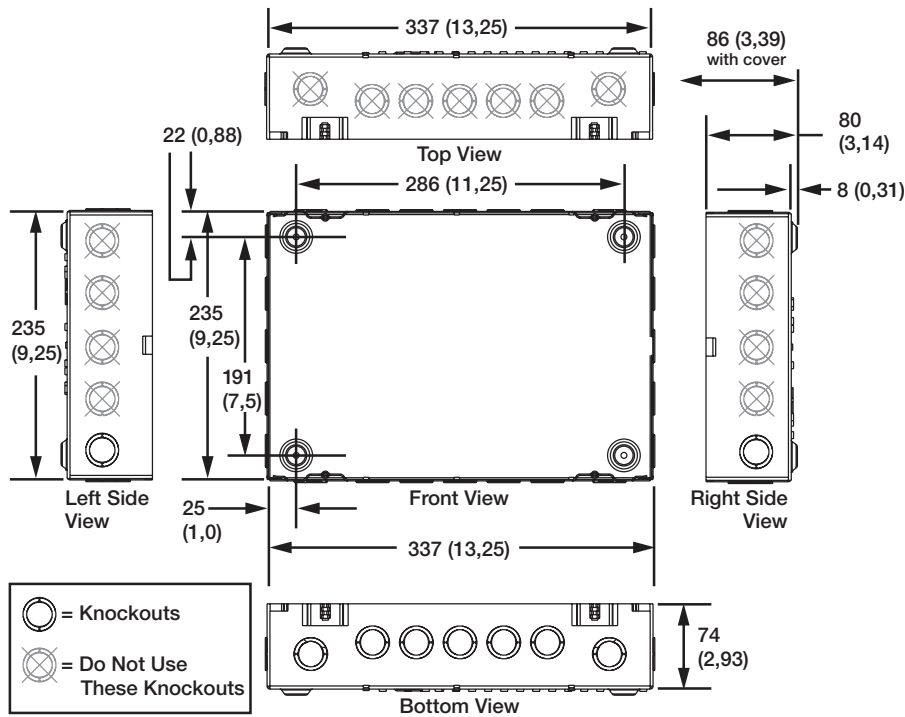

Attention Contractor!

Please use provided knockouts for input mains wiring conduit. Drilling additional holes in enclosure could damage electronic components inside the panel.

Mounting

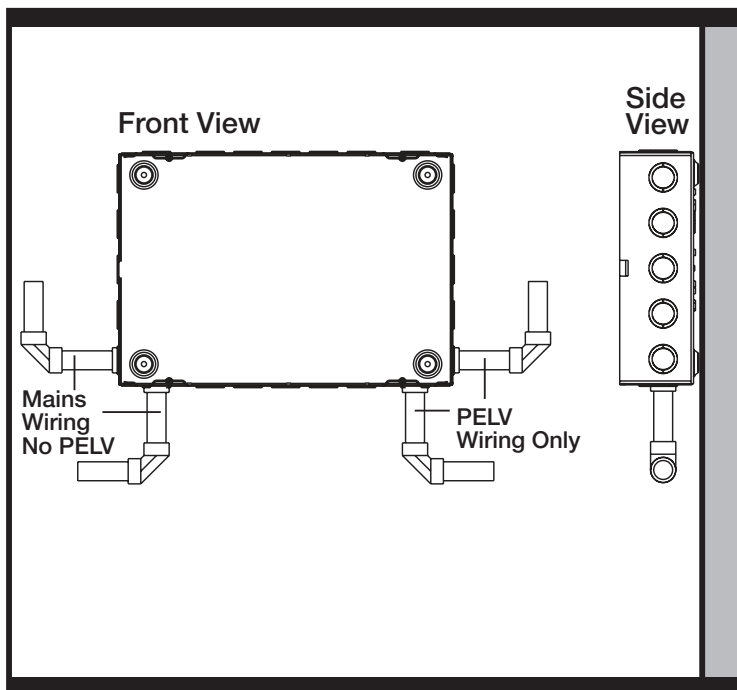

Notes

- For indoor use only.
- Consult dimensions drawing above for panel size, conduit knockouts, and mounting holes.
- Mount where ambient temperature is 0 to 40 °C (32 to 104 °F).
- Reinforce wall structure for weight and local codes as necessary.
- Mount panel so line/mains voltage wiring is at least 1,8 m (6 ft) from sound or electronic equipment and wiring.
- Lutron recommends using 6 mm (0,25 in) mounting bolts.
- Allow 32 mm (1,25 in) clearance on each side of panel for cover.
- Allow 63 mm (2,5 in) between enclosures.
- Panel weight: 8 kg (18 lbs)
- Panel should not be mounted inside another electrical enclosure.

Panel Wiring Instructions



WARNING: Shock Hazard. Turn power OFF to all circuits before installing any part of the dimming system. Wiring with the power on can result in death or serious personal injury.

NOTICE: Verify that the panel is fed from the correct voltage. A feed miswire or loss of a feed neutral can cause damage to the equipment.

1. **Pull dedicated feeds.** Each panel requires a 10 A dedicated feed.
2. **Power and control wires must be run in separate conduit or raceways.** Run individual neutrals for input and each load circuit.
3. **Use 10 A breakers.** Do not exceed 2,1 kW per 10 A circuit. (350 W by 6 zones for 2,1 kW max)
4. **Connect load wires to terminals DL1-DL6.** Connect all load neutrals for each panel to the neutral terminals (N).

Load Types

The panel can control incandescent, halogen (tungsten), magnetic low-voltage, and neon/cold cathode load types. Electronic low-voltage and fluorescent load types can be controlled with an appropriate interface.

- Not all zones need to be connected; however, connected zones must have a load of at least 40 W.
- No zone may be loaded with more than 350 W. Maximum load capacity for each panel is 2,1 kW.
- Panel must not carry more than 8,75 A of total lighting load.
- All Electronic Low-Voltage (ELV) lighting used with the Electronic Low-Voltage Interface must be rated for **reverse phase control dimming**. Before installing an ELV light source, verify with the manufacturer that their transformer can be dimmed. When dimming, an Electronic Low-Voltage Interface **MUST** be used with the panel.

Wiring Note

Use the bottom right knockouts when pulling PELV wires into the main panel, all other knockouts for non-PELV use.

1. Strip 25 mm (1 in) of insulation from the PELV cable.
2. Strip 9 mm (3/8 in) of insulation from each wire.
3. Connect the PELV wires to the PELV terminal block. Make sure no bare wire is exposed after making connections.
4. The recommended installation torque is 0,4 N•m (3,5 in-lb) for PELV connections.

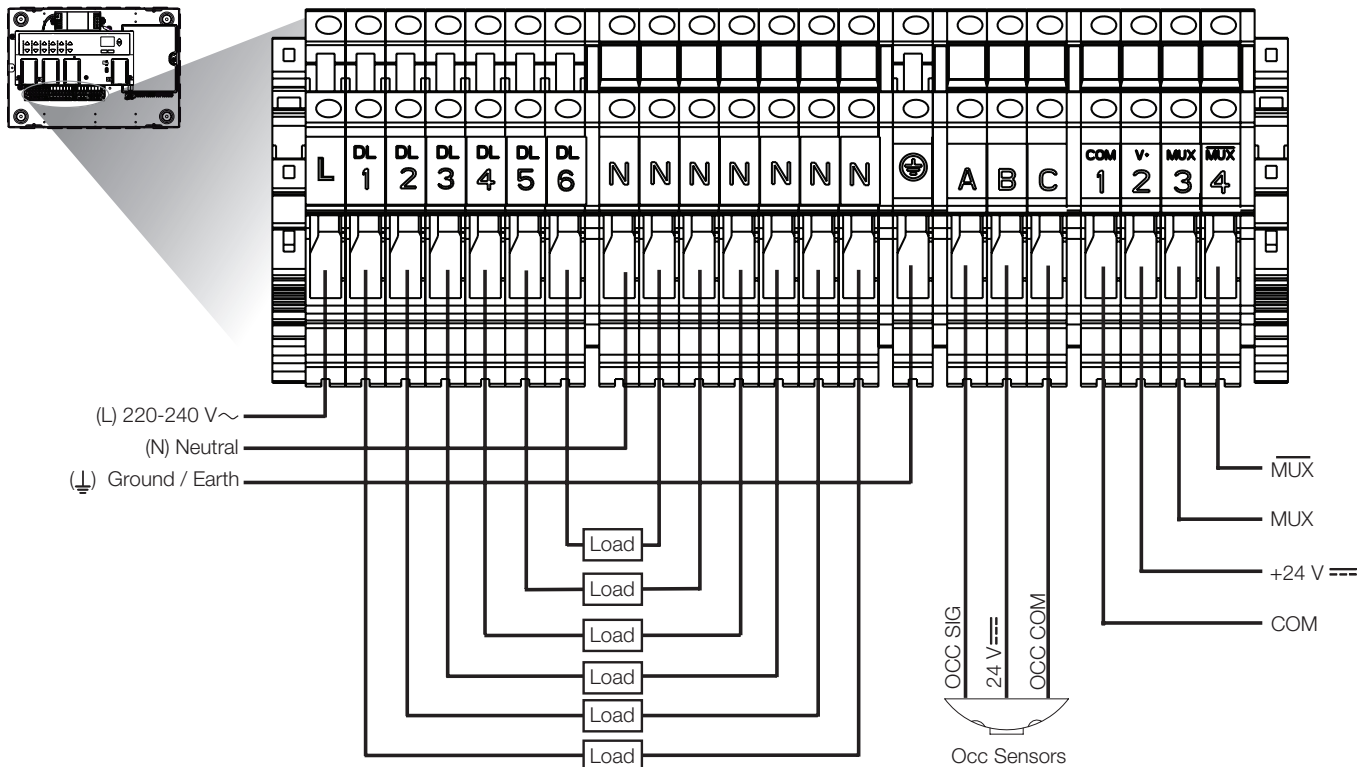

Control Unit Wiring

PELV System Wiring

- System communication uses PELV wiring.
- Wiring can be daisy-chained or T-tapped.
- Wiring must be run separately from line/mains voltage.
- PELV wiring link requires:
 - Two 1,0 mm² (18 AWG) conductors for control power.
 - One twisted, shielded pair of 0,5 mm² (22 AWG) for data link.
 - Available from Lutron, P/N GRX-CBL-346S; check compatibility in your area.
- Total length of control link must not exceed 610 m (2 000 ft).
- Up to 10 wallstations can be powered from each Panel with a power supply (see model descriptions for details).

Panel Wiring Example

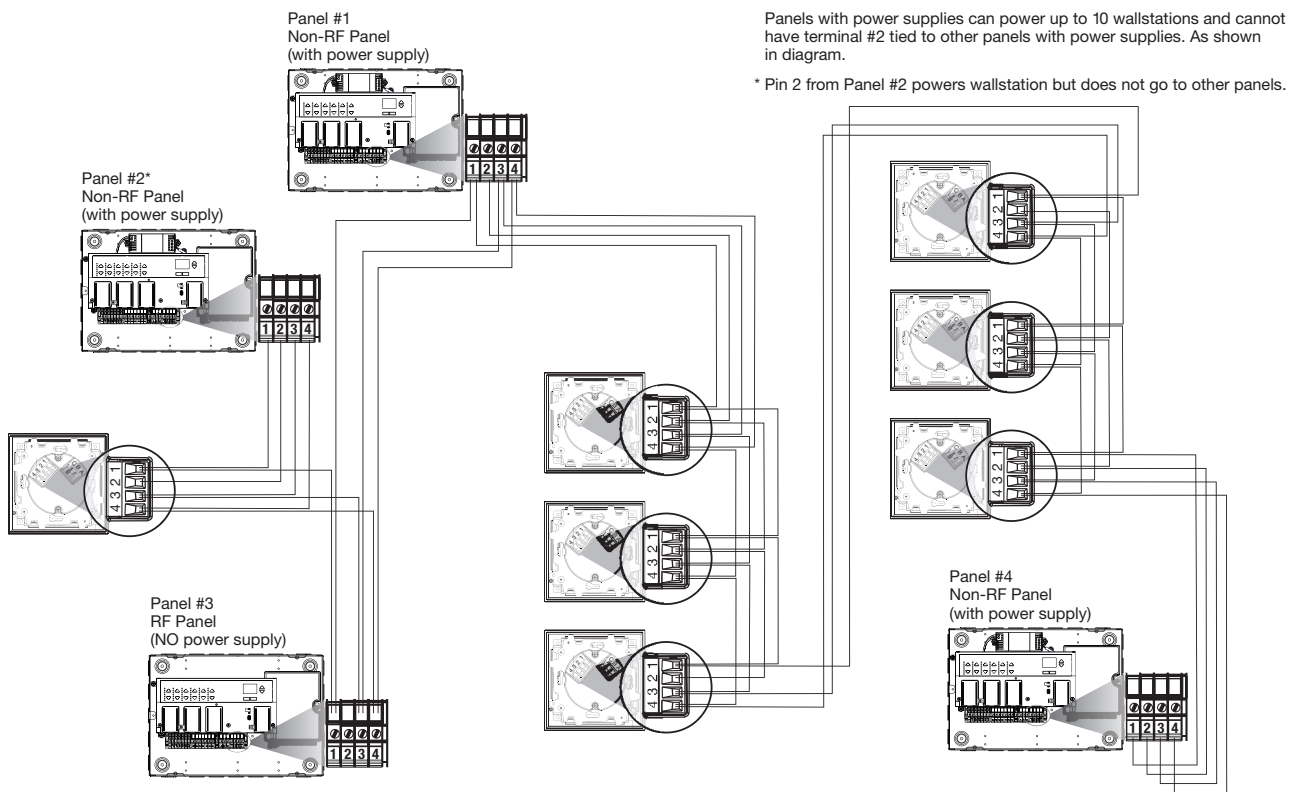

Daisy-Chain Wiring Example

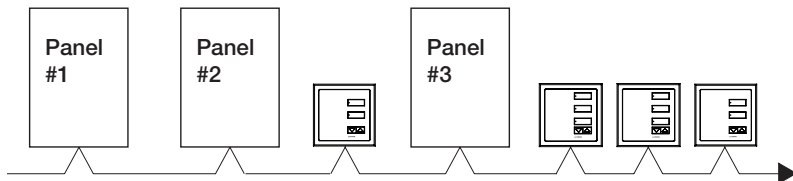

T-Tap Wiring Example

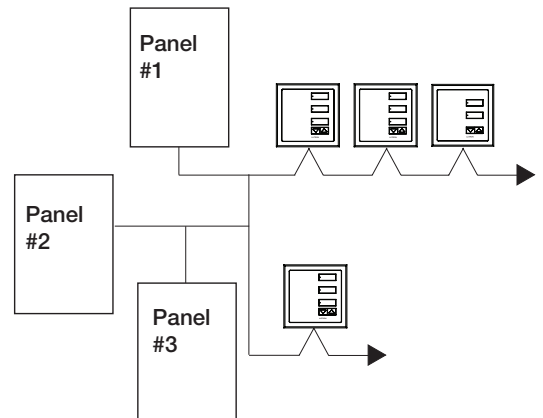

Wallstation Installation

Wallstation Wiring: Panel with up to Ten Wallstation Controls

Each panel with a power supply can power up to ten Wallstation Controls. If you need to power more than ten Wallstation Controls from one panel, install an external 24 V_{DC} power supply.

Maximum of 300 m (1 000 ft) between the Control Unit and the second Wallstation. For longer distances, use an external PELV rated 24 V_{DC} power supply.

IMPORTANT WIRING NOTE:

Daisy-chain the terminal 1, terminal 2, terminal 3, and terminal 4 connections to the panel and Wallstation Controls.

Note: Do not allow PELV wires to contact line/mains wires.

Control Station Device (CSD) Link Wiring

- Use low-voltage PELV wiring to connect Wallstations to the panel link.
- Make connections inside the wallbox or in a switch/ junction box with a maximum wire length of 2,5 m (8 ft) from the link to the Wallstation.
- Strip 9 mm (3/8 in) insulation from both twisted pairs in the wallbox.
- Two 1,0 mm² (18 AWG) conductors for common (terminal 1) and 24 V_{DC} (terminal 2). These will not fit in terminals. Connect as shown.
- One shielded, twisted pair 0,5 mm² (22 AWG) for data link (terminals 3 and 4).
- Connect Drain/Shield as shown. Do not connect to Ground (Earth) or Wallstation. Connect the bare drain wires and cut off the outside shield.

Note: Some Wallstations have a “D” terminal for Drain. The Drain/Shield wire may be connected to this terminal.

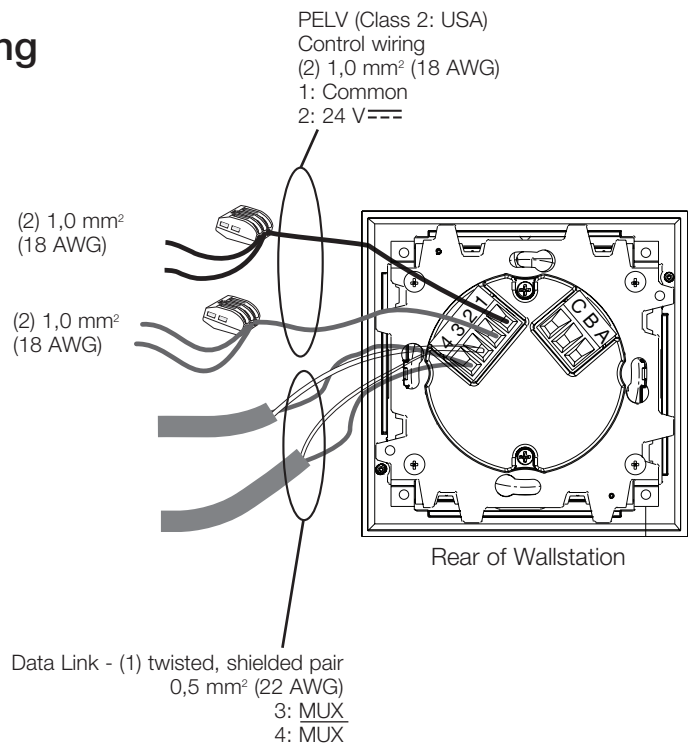

Contact Closure Input Wiring

- Use PELV/SELV wiring to connect the contact closure inputs to the Wallstation.
- Inputs must be dry contact closure or ground referenced solid-state outputs.
- Wallstation is miswire protected up to 36 V.
- Outputs must stay in the closed or open states for at least 40 ms in order to be recognized by the Wallstation.

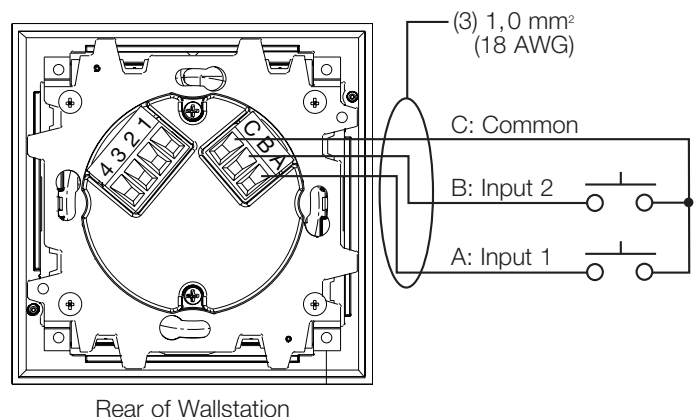

Wallstation Installation (continued)

1. Mount wallbox with appropriate depth.
2. Strip 9 mm (3/8 in) insulation from both twisted pairs in the wallbox.

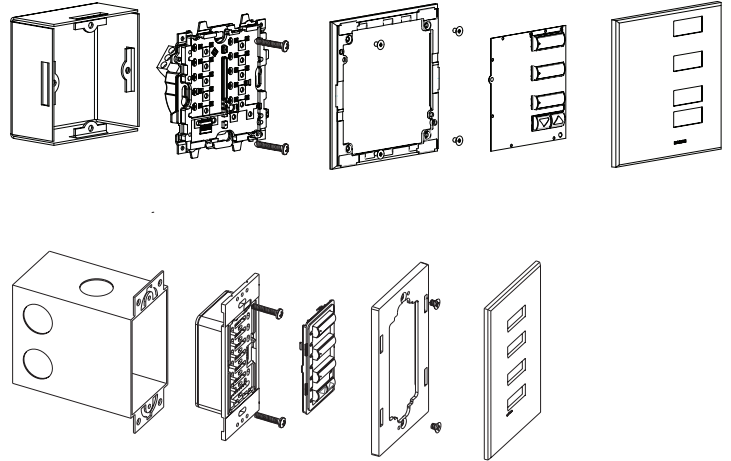

Start-up Procedure

Check Load Circuits

1. Make sure the factory-installed bypass jumper(s) are still in place between the L (Live) and DL (Dimmer Load) terminals. Replace panel cover. Turn circuit breaker on.
2. Check the input current to the L (Live) terminal with a “clamp-on” type current probe. The current probe should measure no more than 8,75 A.
3. Turn loads ON for at least ten minutes. If circuit breaker trips, turn power OFF, then locate and correct miswire or overload.

Check Panel

1. With power OFF, make sure all control wiring is correct. Replace panel cover. Turn circuit breaker on.
2. Push buttons on wallstation control. The lighting should go to full, but the control indicator lights should go on/off.

Remove Bypass Jumpers

1. Turn power OFF.
2. Remove the load circuit bypass jumper from the control panel.
3. Turn power ON. Change the scene buttons on the Grafik Eye® QS to make sure they adjust the light level.

RS232/Ethernet Wiring



WARNING: Shock Hazard. May result in death or serious injury. **DO NOT WIRE LIVE!** Interrupt power via circuit breaker before wiring and servicing.

For Ethernet link, use CAT5 cable (not included) to connect to auxiliary equipment. Maximum length for CAT5 cable is 100 m (328 ft). The Ethernet Link LED will light continuously when the link is present and will flash when there is link activity. Additional Ethernet network equipment and cables not provided.

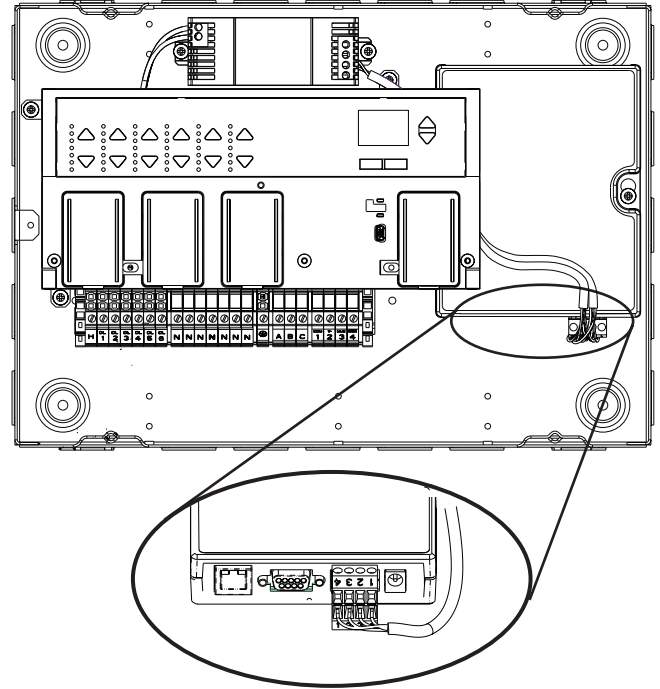

Network Connections

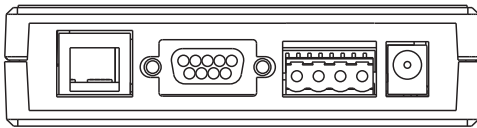

Ethernet Link RS232 Link Data Link (to control units, processors, and wallstations)

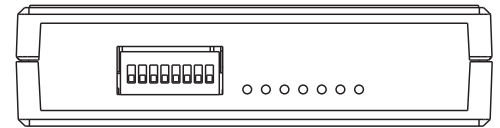

DIP Switches LED 1: Power
LED 2, 3: Unused
LED 4: RS232 Link Tx
LED 5: RS232 Link Rx
LED 6: Data Link Tx
LED 7: Data Link Rx

Ethernet Interface Wiring

RS232 Link Wiring

- Standard 9-pin serial connector plugs into RS232 equipment, and to Ethernet Interface.
- Must be 15 m (50 ft) or less.

| RS232 Signals | |
|---------------|--------------------|
| Signals | Pin on 9-pin Cable |
| Com | 5 |
| TxD | 3 |
| RxD | 2 |

Ethernet Link Wiring

- Standard CAT5 cable connects Ethernet Interface to PC, router, or other Ethernet source.
- No crossover cable needed.
- Should not exceed 100 m (328 ft).
- Ethernet network and cable not provided.

Contact Closure Wiring

Contact Closure Ratings

Five Input Terminals

- Accepts maintained inputs and momentary inputs with 40 ms minimum pulse times.
- Off-state leakage current must be less than 100 μ A.
- Open circuit voltage: 24 V $\overline{\text{DC}}$ maximum.
- Inputs must be dry contact closure, solid state, open collector, or active-low (NPN)/active high (PNP) output.
 - Open collector NPN or active-low on-state voltage must be less than 2 V and sink 3,0 mA.
 - Open collector PNP or active-high on-state voltage must be greater than 12 V and source 3,0 mA.
- Lutron recommends a maximum of 3 occupant sensors wired in parallel per input.

Five Output Terminals

- Provide selectable maintained or momentary (250 ms) outputs.
- The interface is not rated to control unclamped, inductive loads. Inductive loads include, but are not limited to, relays, solenoids, and motors. To control these types of equipment, a flyback diode must be used (DC voltages only). See diagram below.
- Output relays are non-latching (i.e. if relays are closed and power is lost, relays will open).

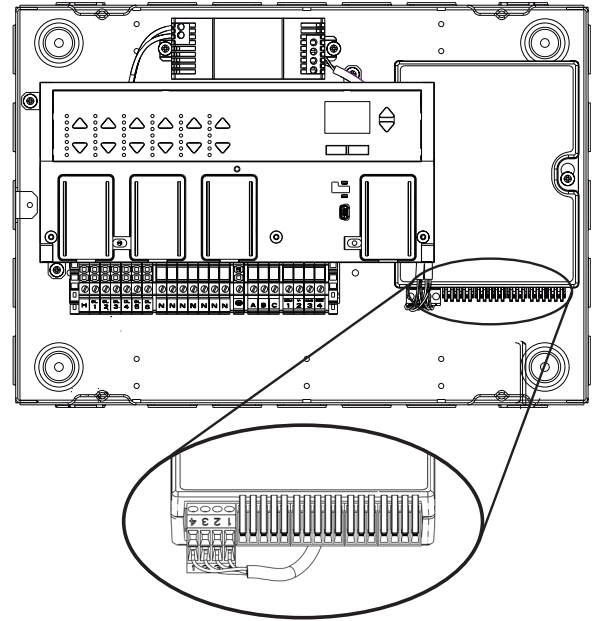

IO Connections

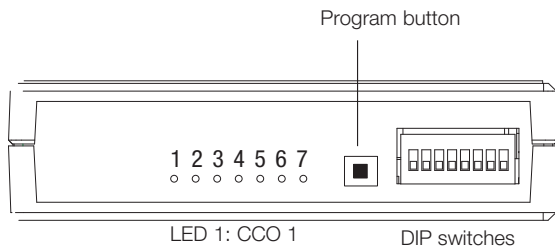

LED 1: CCO 1
 LED 2: CCO 2
 LED 3: CCO 3
 LED 4: CCO 4
 LED 5: CCO 5
 LED 6: Unused
 LED 7: Status

Notes: CCO LED is ON when CCO NO (normally open contact) is closed.
 Status LED blinks once per second during normal operation

Output Ratings

| Supply Voltage | Resistive Load |
|---------------------------------|----------------|
| 0 - 24 V $\overline{\text{DC}}$ | 1,0 A |
| 0 - 24 V \sim | 0,5 A |

Data Link (to wallstations)

- 1: Common
- 2: 24 V $\overline{\text{DC}}$
- 3: MUX
- 4: MUX

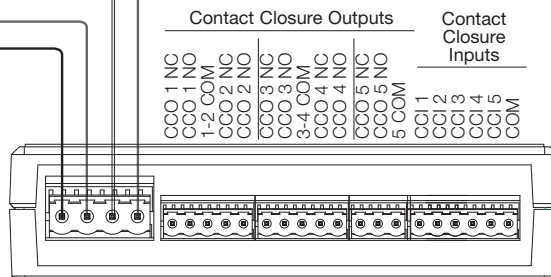

NC = Normally closed
 NO = Normally open

CCO and CCI connectors hold one 0,08 - 1,5 mm² (28 - 16 AWG) wire

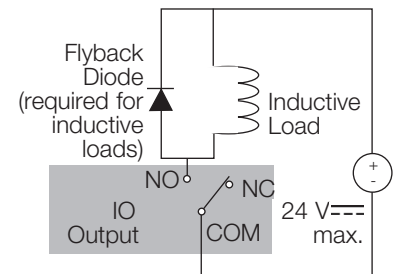

Warranty

Lutron Electronics Co., Inc.

One Year Limited Warranty

For a period of one year from the date of purchase, and subject to the exclusions and restrictions described below, Lutron warrants each new unit to be free from manufacturing defects. Lutron will, at its option, either repair the defective unit or issue a credit equal to the purchase price of the defective unit to the Customer against the purchase price of comparable replacement part purchased from Lutron. Replacements for the unit provided by Lutron or, at its sole discretion, an approved vendor may be new, used, repaired, reconditioned, and/or made by a different manufacturer.

If the unit is commissioned by Lutron or a Lutron approved third party as part of a Lutron commissioned lighting control system, the term of this warranty will be extended, and any credits against the cost of replacement parts will be prorated, in accordance with the warranty issued with the commissioned system, except that the term of the unit's warranty term will be measured from the date of its commissioning.

EXCLUSIONS AND RESTRICTIONS

This Warranty does not cover, and Lutron and its suppliers are not responsible for:

1. Damage, malfunction or inoperability diagnosed by Lutron or a Lutron approved third party as caused by normal wear and tear, abuse, misuse, incorrect installation, neglect, accident, interference or environmental factors, such as (a) use of incorrect line voltages, fuses or circuit breakers; (b) failure to install, maintain and operate the unit pursuant to the operating instructions provided by Lutron and the applicable provisions of the National Electrical Code and of the Safety Standards of Underwriter's Laboratories; (c) use of incompatible devices or accessories; (d) improper or insufficient ventilation; (e) unauthorized repairs or adjustments; (f) vandalism; or (g) an act of God, such as fire, lightning, flooding, tornado, earthquake, hurricane or other problems beyond Lutron's control.
2. On-site labor costs to diagnose issues with, and to remove, repair, replace, adjust, reinstall and/or reprogram the unit or any of its components.
3. Equipment and parts external to the unit, including those sold or supplied by Lutron (which may be covered by a separate warranty).
4. The cost of repairing or replacing other property that is damaged when the unit does not work properly, even if the damage was caused by the unit.

EXCEPT AS EXPRESSLY PROVIDED IN THIS WARRANTY, THERE ARE NO EXPRESS OR IMPLIED WARRANTIES OF ANY TYPE, INCLUDING ANY IMPLIED WARRANTIES OF FITNESS FOR A PARTICULAR PURPOSE OR MERCHANTABILITY. LUTRON DOES NOT WARRANT THAT THE UNIT WILL OPERATE WITHOUT INTERRUPTION OR BE ERROR FREE.

NO LUTRON AGENT, EMPLOYEE OR REPRESENTATIVE HAS ANY AUTHORITY TO BIND LUTRON TO ANY AFFIRMATION, REPRESENTATION OR WARRANTY CONCERNING THE UNIT. UNLESS AN AFFIRMATION, REPRESENTATION OR WARRANTY MADE BY AN AGENT, EMPLOYEE OR REPRESENTATIVE IS SPECIFICALLY INCLUDED HEREIN, OR IN STANDARD PRINTED MATERIALS PROVIDED BY LUTRON, IT DOES NOT FORM A PART OF THE BASIS OF ANY BARGAIN BETWEEN LUTRON AND CUSTOMER AND WILL NOT IN ANY WAY BE ENFORCEABLE BY CUSTOMER.

IN NO EVENT WILL LUTRON OR ANY OTHER PARTY BE LIABLE FOR EXEMPLARY, CONSEQUENTIAL, INCIDENTAL OR SPECIAL

DAMAGES (INCLUDING, BUT NOT LIMITED TO, DAMAGES FOR LOSS OF PROFITS, CONFIDENTIAL OR OTHER INFORMATION, OR PRIVACY; BUSINESS INTERRUPTION; PERSONAL INJURY; FAILURE TO MEET ANY DUTY, INCLUDING OF GOOD FAITH OR OF REASONABLE CARE; NEGLIGENCE, OR ANY OTHER PECUNIARY OR OTHER LOSS WHATSOEVER), NOR FOR ANY REPAIR WORK UNDERTAKEN WITHOUT LUTRON'S WRITTEN CONSENT ARISING OUT OF OR IN ANY WAY RELATED TO THE INSTALLATION, DEINSTALLATION, USE OF OR INABILITY TO USE THE UNIT OR OTHERWISE UNDER OR IN CONNECTION WITH ANY PROVISION OF THIS WARRANTY, OR ANY AGREEMENT INCORPORATING THIS WARRANTY, EVEN IN THE EVENT OF THE FAULT, TORT (INCLUDING NEGLIGENCE), STRICT LIABILITY, BREACH OF CONTRACT OR BREACH OF WARRANTY OF LUTRON OR ANY SUPPLIER, AND EVEN IF LUTRON OR ANY OTHER PARTY WAS ADVISED OF THE POSSIBILITY OF SUCH DAMAGES.

NOTWITHSTANDING ANY DAMAGES THAT CUSTOMER MIGHT INCUR FOR ANY REASON WHATSOEVER (INCLUDING, WITHOUT LIMITATION, ALL DIRECT DAMAGES AND ALL DAMAGES LISTED ABOVE), THE ENTIRE LIABILITY OF LUTRON AND OF ALL OTHER PARTIES UNDER THIS WARRANTY ON ANY CLAIM FOR DAMAGES ARISING OUT OF OR IN CONNECTION WITH THE MANUFACTURE, SALE, INSTALLATION, DELIVERY, USE, REPAIR, OR REPLACEMENT OF THE UNIT, OR ANY AGREEMENT INCORPORATING THIS WARRANTY, AND CUSTOMER'S SOLE REMEDY FOR THE FOREGOING, WILL BE LIMITED TO THE AMOUNT PAID TO LUTRON BY CUSTOMER FOR THE UNIT. THE FOREGOING LIMITATIONS, EXCLUSIONS AND DISCLAIMERS WILL APPLY TO THE MAXIMUM EXTENT ALLOWED BY APPLICABLE LAW, EVEN IF ANY REMEDY FAILS ITS ESSENTIAL PURPOSE.

TO MAKE A WARRANTY CLAIM

To make a warranty claim, promptly notify Lutron within the warranty period described above by calling the Lutron Technical Support Center at (800) 523-9466. Lutron, in its sole discretion, will determine what action, if any, is required under this warranty. To better enable Lutron to address a warranty claim, have the unit's serial and model numbers available when making the call. If Lutron, in its sole discretion, determines that an on-site visit or other remedial action is necessary, Lutron may send a Lutron Services Co. representative or coordinate the dispatch of a representative from a Lutron approved vendor to Customer's site, and/or coordinate a warranty service call between Customer and a Lutron approved vendor.

This warranty gives you specific legal rights, and you may also have other rights which vary from state to state. Some states do not allow limitations on how long an implied warranty lasts, so the above limitation may not apply to you. Some states do not allow the exclusion or limitation of incidental or consequential damages, so the above limitation or exclusion may not apply to you.

Lutron, the sunburst logo, Grafik Eye, and seeTouch are registered trademarks of Lutron Electronics Co., Inc.

© 2010 Lutron Electronics Co., Inc.

Contact Information

Internet: www.lutron.com
E-mail: product@lutron.com

WORLD HEADQUARTERS

USA

Lutron Electronics Co., Inc.
7200 Suter Road
Coopersburg, PA 18036-1299
TEL +1.610.282.3800
FAX +1.610.282.1243
Toll-Free 1.888.LUTRON1
Technical Support 1.800.523.9466

North and South America Technical Hotlines
USA, Canada, Caribbean: 1.800.523.9466
Mexico: +1.888.235.2910
Central/South America: +1.610.282.6701

EUROPEAN HEADQUARTERS

United Kingdom

Lutron EA Ltd.
6 Sovereign Close, London
E1W 3JF United Kingdom
TEL +44.(0)20.7702.0657
FAX +44.(0)20.7480.6899
FREEPHONE (UK) 0800.282.107
Technical support +44.(0)20.7680.4481

ASIAN HEADQUARTERS

Singapore

Lutron GL Ltd.
15 Hoe Chiang Road
#07-03 Euro Asia Centre
Singapore 089316
TEL +65.6220.4666
FAX +65.6220.4333

Asia Technical Hotlines

Northern China: 10.800.712.1536
Southern China: 10.800.120.1536
Hong Kong: 800.901.849
Indonesia: 001.803.011.3994
Japan: +81.3.5575.8411
Macau: 0800.401
Singapore: 800.120.4491
Taiwan: 00.801.137.737
Thailand: 001.800.120.665853
Other countries: +65.6220.4666

The following apply:

Observe all national and local electrical codes, safety standards, and building codes.
Disconnect all power sources before wiring or servicing unit.
Use certified cable for all Line Voltage/Mains cables and PELV cables.
Reinforce mounting structure as required for weight and local codes.
Do not exceed the capacity rating of the unit.
Use indoors only.
Clean with a soft damp cloth only. Do not use any chemical cleaners.

The following may also apply:

Do not connect high-voltage power to low voltage terminals.
Do not operate a dimmed low-voltage circuit without operative lamps in place.
Use transformers with thermal protection or fused primary transformer windings.
Earth ground all ballast cases and fixtures.



Soluciones para habitaciones seeTouch®

Guía de instalación

Lea la información siguiente

230 V~ 50/60 Hz 8,75 A (40 – 350 W por zona)

24 V= 200 mA (Cuadros con sólo una fuente de alimentación)

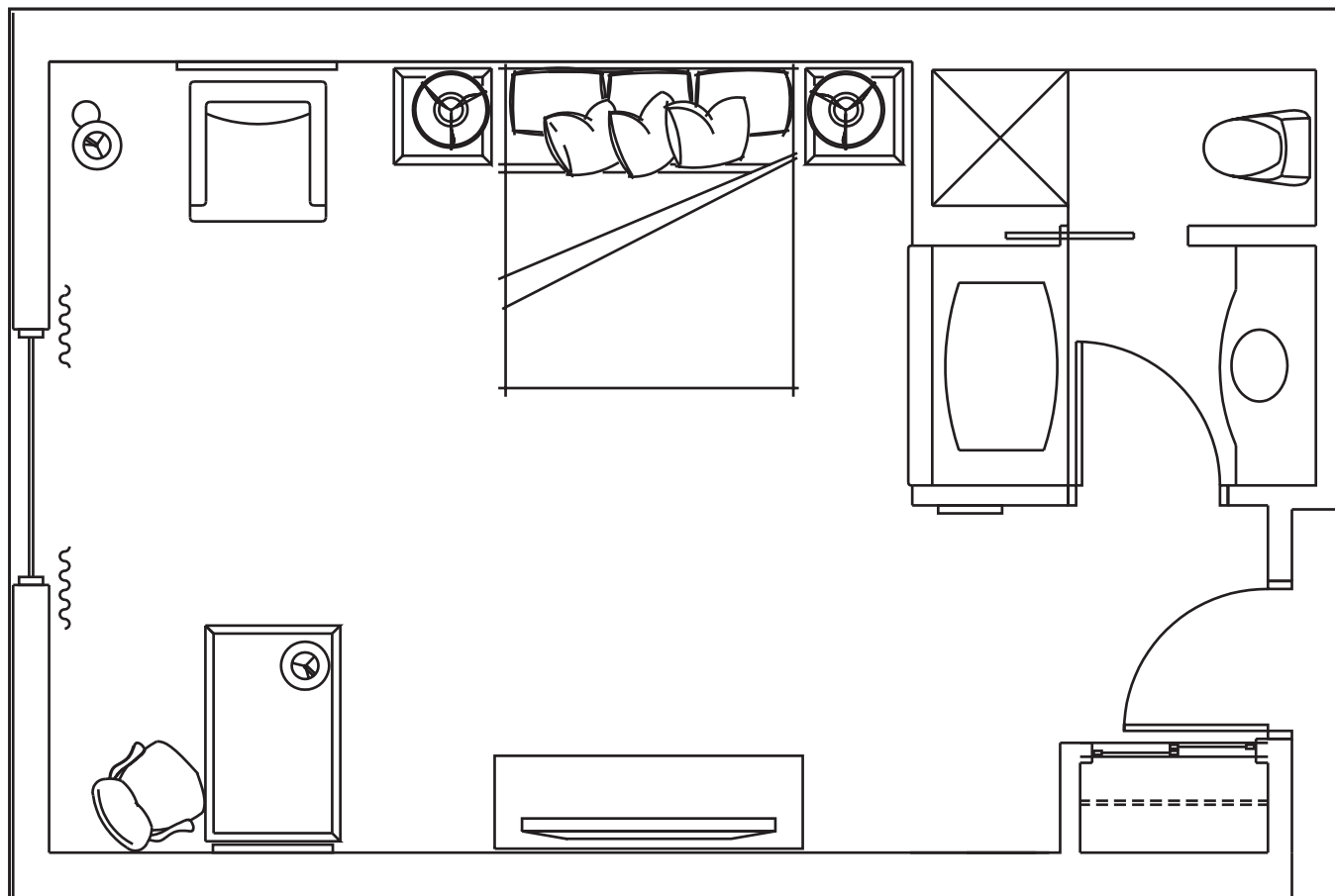

IMPORTANTE:

- Los controles de iluminación deberán ser instalados por un electricista cualificado según la normativa vigente.



ADVERTENCIA: Peligro de descargas. Puede causar lesiones graves o mortales. NO REALICE LA CONEXIÓN CON CORRIENTE. Interrumpa la alimentación a través del magnetotérmico antes del cableado y servicio.

- Desconecte siempre la protección magnetotérmica o quite el fusible general de la línea de alimentación antes de realizar cualquier trabajo.
- Para reducir el riesgo de sobrecalentamiento y posibles daños a los equipos, el módulo deberá montarse como se muestra. Si no se dispone del espacio adecuado para el enfriamiento, podría producirse un sobrecalentamiento y quedaría anulada la garantía.
- El módulo zumba ligeramente durante el funcionamiento y el relé interno emite clics cuando se activa y desactiva el circuito. Elija una ubicación de instalación donde estos sonidos sean aceptables.
- Los controles de iluminación se han diseñado exclusivamente para uso comercial en interiores.
- Este control utiliza métodos de cableado PELV. Consulte a su compañía eléctrica local el cumplimiento de los códigos nacionales y locales y las prácticas de cableado.

Índice

Índice

| | |
|--|----|
| Perspectiva general | 3 |
| Dimensiones y montaje | 4 |
| Cableado del cuadro | 5 |
| Cableado de la unidad de control | 6 |
| Instalación de la unidad de control de pared | 7 |
| Procedimiento de puesta en marcha | 8 |
| Cableado Ethernet | 9 |
| Cableado de cierre de contacto | 10 |
| Garantía | 11 |
| Información de contacto | 12 |

Perspectiva general

Accionada por un cuadro de regulación de diseño de precisión, la nueva solución para habitaciones seeTouch® es una solución de control de iluminación asequible, de fácil instalación para habitaciones de hotel.

Detalles del cuadro

Descripción

- Permite configurar escenas de luces y posiciones predefinidas de cortinas con los botones de cuadro.
- Controla muchos tipos de fuentes de iluminación directamente, y otros con la utilización de interfaces de potencia.
- Proporciona control individual de las fuentes de iluminación.
- Incluye reloj astronómico integrado.
- Incluye una entrada de cierre de contacto y alimentación de 24 V $\overline{=}$ para sensores de presencia u otros dispositivos de gestión del edificio.
- Incluye enlace de comunicación para una perfecta integración de las luces, cortinas motorizadas y estaciones de control.
- Compatible con todos los componentes del sistema Lutron® QS.

Medidas

Todas las dimensiones en mm

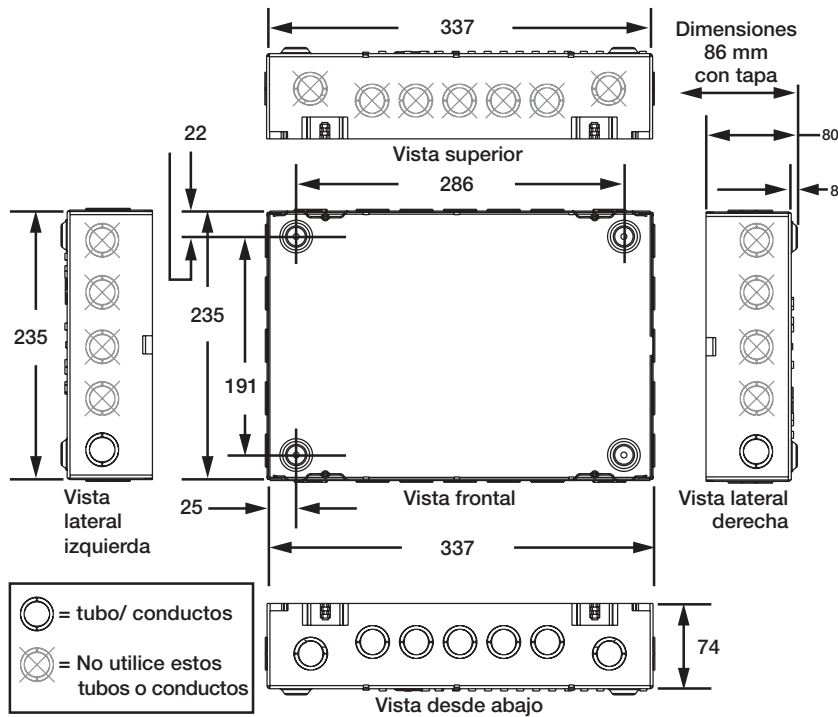

¡Atención, contratista!

Utilice los tubos/canalizaciones suministrados para el conducto de cableado de red. La realización de orificios adicionales podría dañar los componentes electrónicos del interior del cuadro.

Montaje

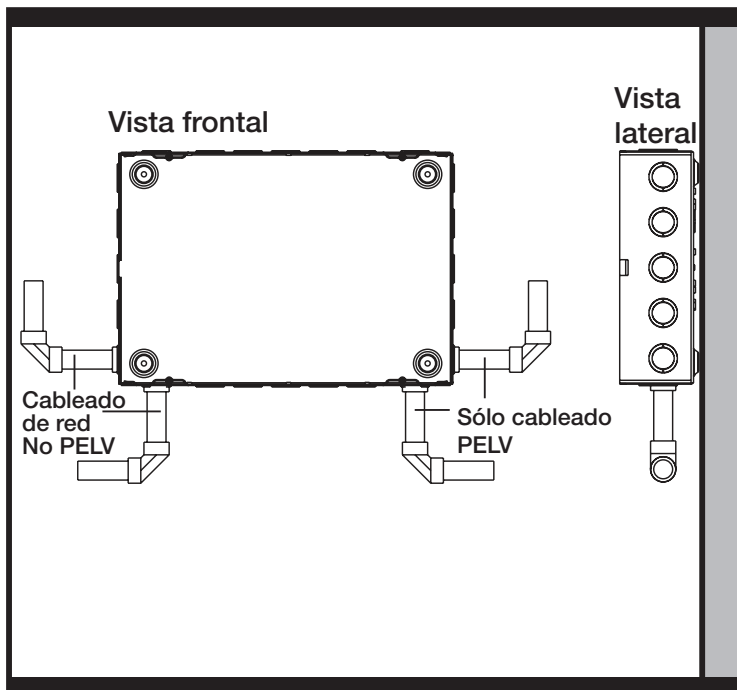

Notas:

- Sólo para uso en interiores.
- Consulte en el gráfico de dimensiones anterior los tamaños de los cuadros, tubo/canalizaciones y orificios de montaje.
- Deberán instalarse sólo donde la temperatura ambiente sea de 0 a 40 °C.
- Refuerce la estructura de la pared de acuerdo al peso y a las normas locales, según sea necesario.
- Instale el cuadro de modo que la alimentación del cuadro quede alejada un mínimo de 1,8 m de otros equipos electrónicos o de audio y su cableado
- Lutron recomienda la utilización de pernos de fijación de 6 mm.
- Deje una distancia de 32 mm en cada lado del cuadro para la colocación de la tapa.
- Deje una distancia de 63 mm entre gabinetes.
- Peso del cuadro: 8 kg.
- El cuadro se montará en el interior de otro armario eléctrico.

seeTouch® 客房解决方案

安装指南

请阅读

230 V~ 50/60 Hz 8.75 A (每光区 40 – 350 W)

24 V== 200 mA (仅限带电源的电柜)

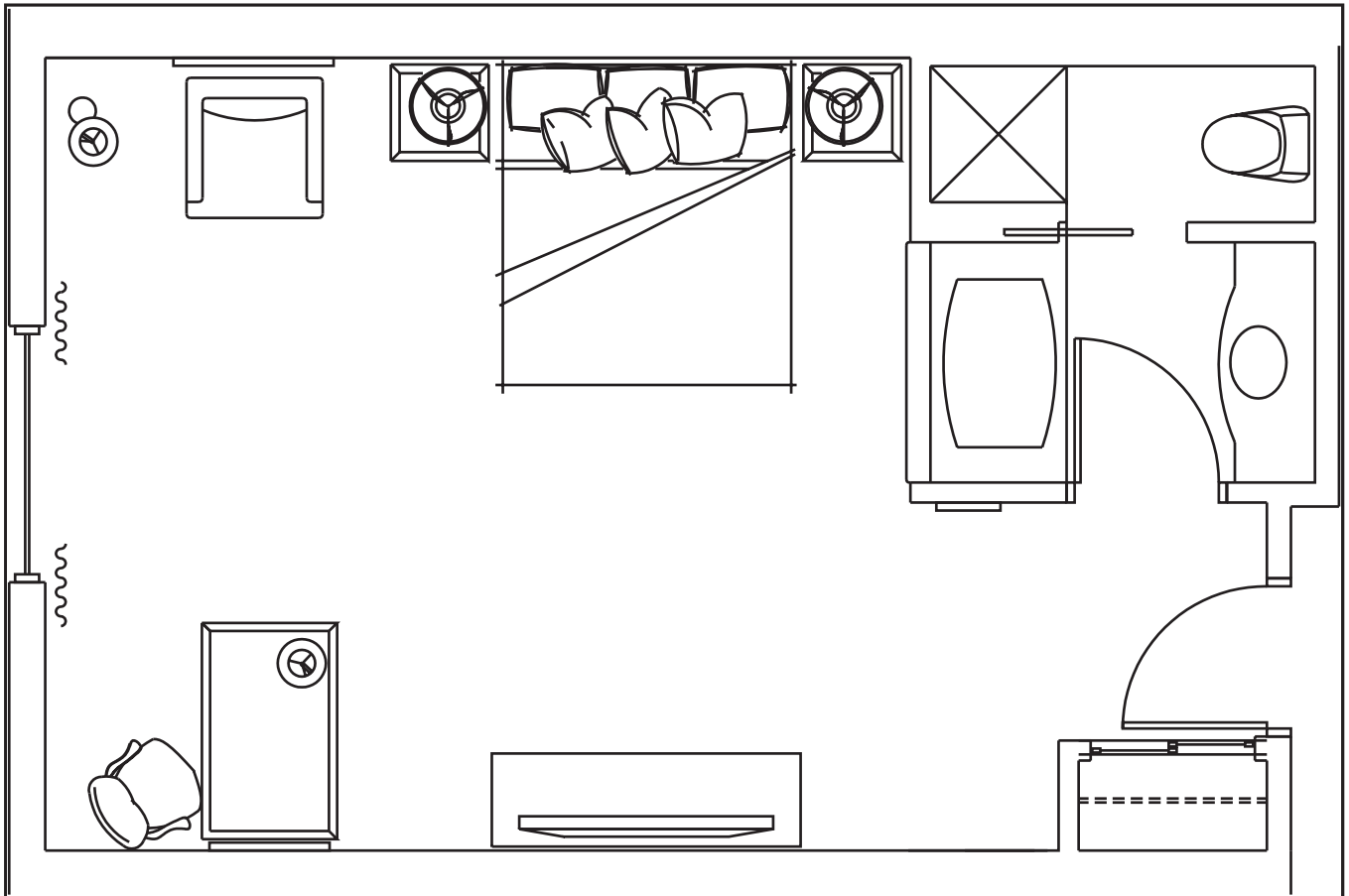

重要:

- 照明控制器必须由合格的电工按照所有适用规定进行安装。



警告：电击危险。可导致死亡或严重受伤事故。切勿带电接线！进行接线和检修之前，应先通过断路器切断电源。

- 进行任何操作之前，要关掉断路器（MCB）或取下电力线路的主保险丝。
- 为了避免过热和可能损坏其它设备，必须如图所示安装模块：未能提供足够的冷却空间可能会导致过热并使质量保证失效。
- 模块在工作时会发出轻微的嗡嗡声，而且其内部继电器会在回路接通和关闭时发出咔嗒声。安装位置应选择在可容忍有这些声音的地方。
- 照明控制器只能安装在室内使用。
- 此控制器采用 PELV 接线法。请与当地的电工行业督查员联系，以了解当地的和国家的规定及接线规范。

目录

目录

| | |
|---------|----|
| 概述 | 3 |
| 尺寸和安装 | 4 |
| 电柜接线 | 5 |
| 控制器接线 | 6 |
| 墙控制器的安装 | 7 |
| 调试步骤 | 8 |
| 以太网接线 | 9 |
| 触点闭合的接线 | 10 |
| 质量保证 | 11 |
| 联系信息 | 12 |

概述

全新的 seeTouch® 客房解决方案采用一个精确设计的调光电柜, 是一款具有成本效益, 又易于安装的酒店客房照明控制解决方案。

电柜细节

说明

- 可用电柜上的按键设定照明场景和窗帘预设。
- 可直接控制多种光源类型, 并可利用电源接口控制其它光源。
- 可对各光源进行单独控制。
- 包括内置天文时钟。
- 包括一路触点闭合输入和供占空传感器或其它楼宇管理系统用的 24 V \equiv 电源。
- 包括可用于无缝集成灯光、电动窗帘系统和控制站的通讯链路。
- 与所有的路创 Lutron® QS 系统组件兼容。

尺寸

所有尺寸均为毫米

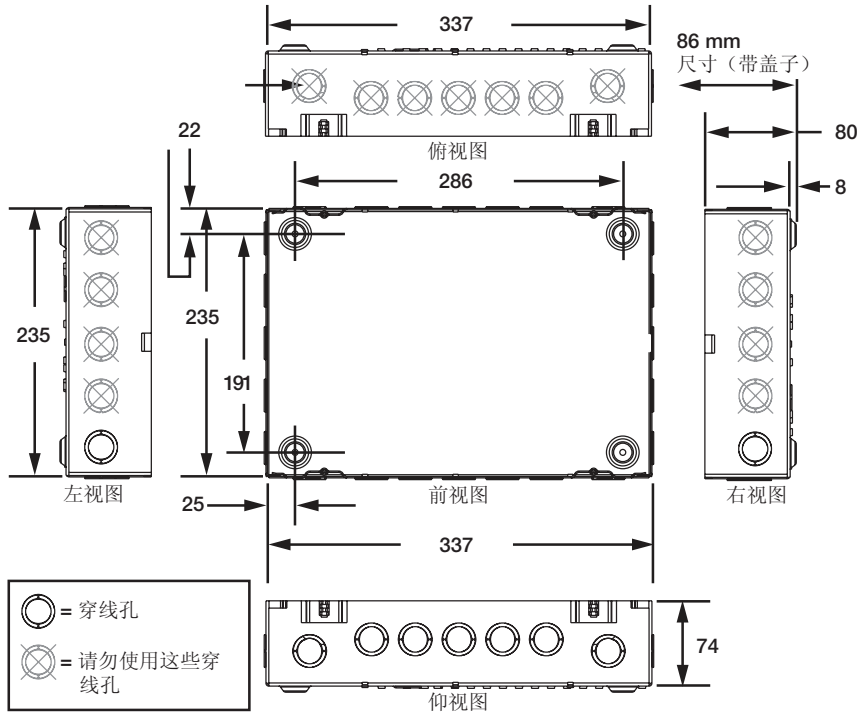

承包商请注意！

请使用为干线输入接线套管所提供的穿线孔。在封挡电柜内另行钻孔可能会损坏电柜内的电子部件。

安装

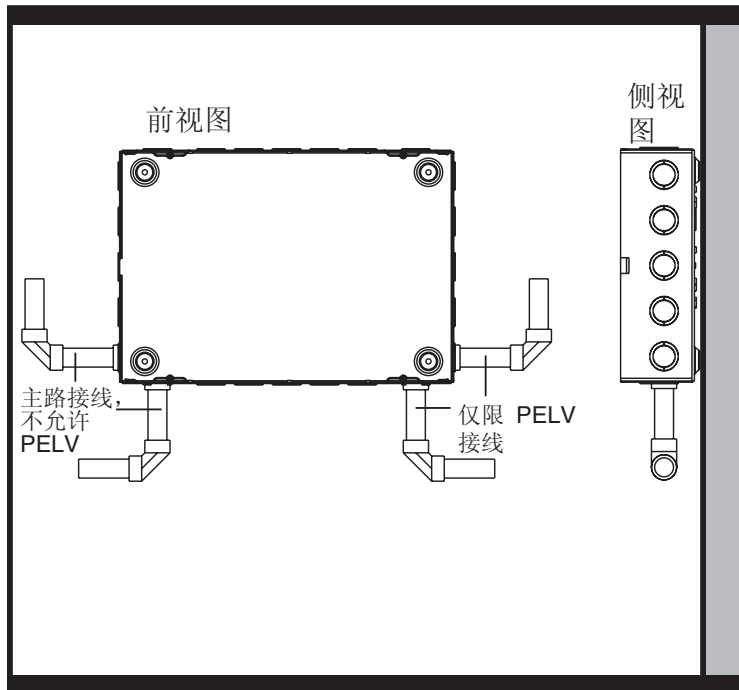

注释

- 仅限室内使用。
- 有关电柜尺寸、穿线孔和安装孔的位置，请参见上面的尺寸图。
- 请安装在环境温度为 0 至 40 °C 的地方。
- 可根据需要，按照承重及当地的规定加固墙体结构。
- 安装电柜时应让线路 / 主路电压的走线离音响或电子设备及接线至少 1.8 米远。
- 路创建议使用 6 毫米的安装螺栓。
- 电柜各侧留出 32 毫米的间隙以安装外盖。
- 封挡电柜之间应留出 63 毫米间隙。
- 电柜重量：8 kg
- 电柜应安装在另一个电气罩壳里。

Решения seeTouch® для гостиничных номеров

Руководство по установке

Просим ознакомиться

230 В ~ 50/60 Гц 8,75 А (40 – 350 Вт на зону)

24 В = 200 мА (только панели с источником питания)

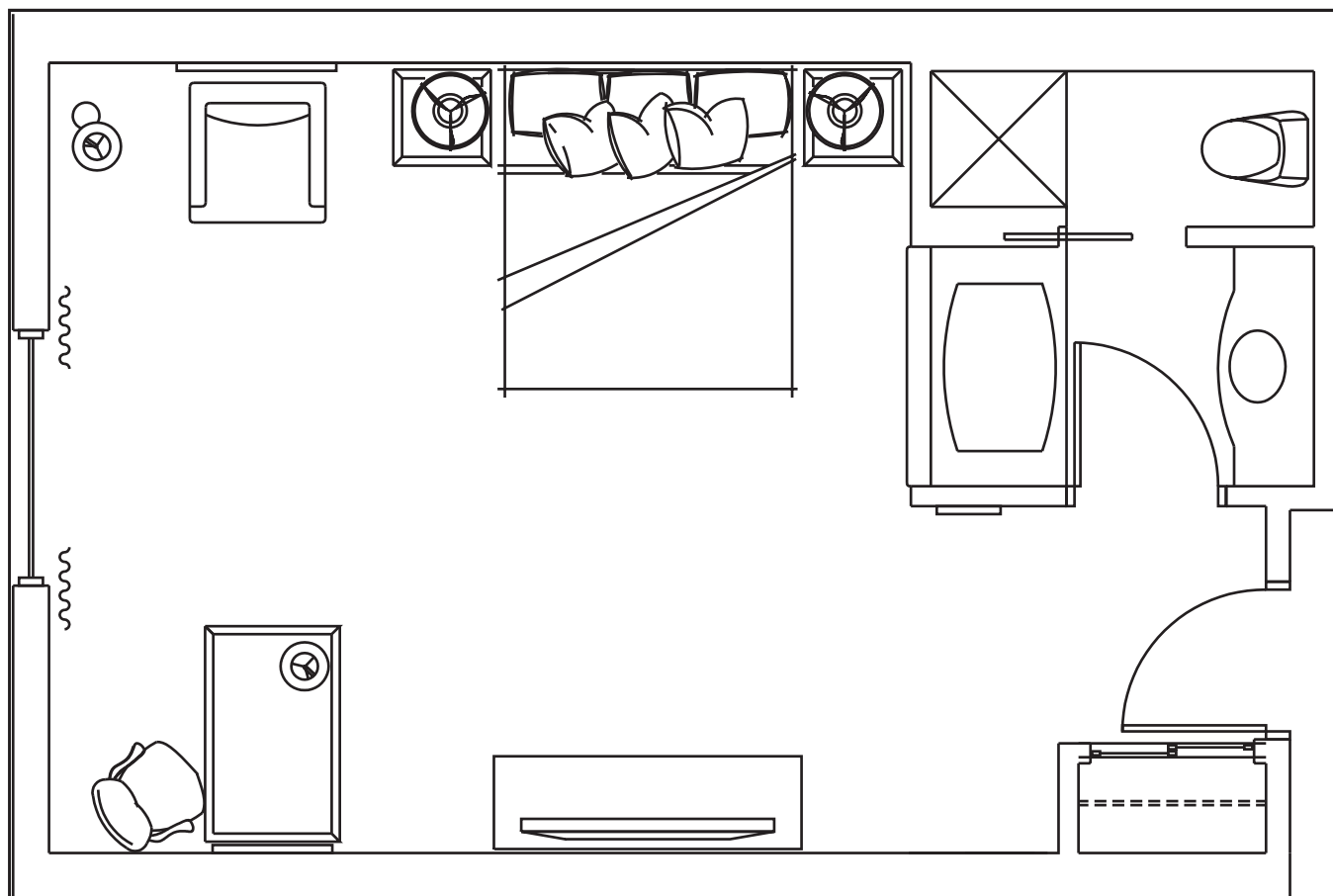

ВАЖНО:

- Устройства управления освещением должны устанавливаться квалифицированным электриком с учетом всех применимых нормативных требований.



ВНИМАНИЕ: опасность поражения электрическим током. Вероятность получения тяжелых травм или смертельного исхода. НЕ ПОДКЛЮЧАТЬ ПОД НАПРЯЖЕНИЕМ! Перед тем как приступить к подключению или техническому обслуживанию, отключите питание выключателем цепи.

- Перед выполнением любых работ всегда отключать питание выключателем или вынимать главный предохранитель силовой линии.
- Для снижения риска перегрева и возможного повреждения другого оборудования щит должен быть установлен, как показано на схеме. Недостаток пространства, необходимого для охлаждения, может привести к перегреву и отмене гарантии.
- Во время работы щит слабо гудит, а внутренние реле при включении и выключении цепи – щелкают. Следует выбрать такое место установки, где эти звуки приемлемы.
- Устройства управления освещением разработаны только для использования внутри помещений для коммерческого использования.
- Эти устройства подключаются по стандарту PELV. Следует проверить с местным инспектором соответствие электрооборудования национальным и местным нормам и правилам, а также практике электромонтажа.

Содержание

Содержание

| | |
|------------------------------------|----|
| Общие сведения | 3 |
| Размеры и монтаж | 4 |
| Подключение щита | 5 |
| Подключение устройства управления | 6 |
| Установка кнопочной панели | 7 |
| Порядок ввода в эксплуатацию | 8 |
| Подключение Ethernet | 9 |
| Подключение контактного интерфейса | 10 |
| Гарантия | 11 |
| Контактная информация | 12 |

Общие сведения

Управляемое прецизионным диммерным устройством, система seeTouch® для гостиничных номеров – это экономичное и простое в установке решение по управлению освещением в гостиничных номерах.

Характеристики устройства

Описание

- Возможность настройки световых сцен и положения штор с помощью кнопок на панели.
- Непосредственное управление осветительными источниками разных типов и другими устройствами через силовые интерфейсы.
- Раздельное управление осветительными источниками.
- Включает в себя встроенный астрономический таймер.
- Имеет один вход с замыкающими контактами и выход питания 24 В $\overline{=}$ для датчиков присутствия или других систем автоматизации здания.
- Имеет линию связи для полной интеграции управления источниками освещения, системами моторизованного управления шторами и управляющими станциями.
- Совместимость со всеми компонентами системы QS Lutron®.

Габаритные размеры

Все размеры указаны в мм

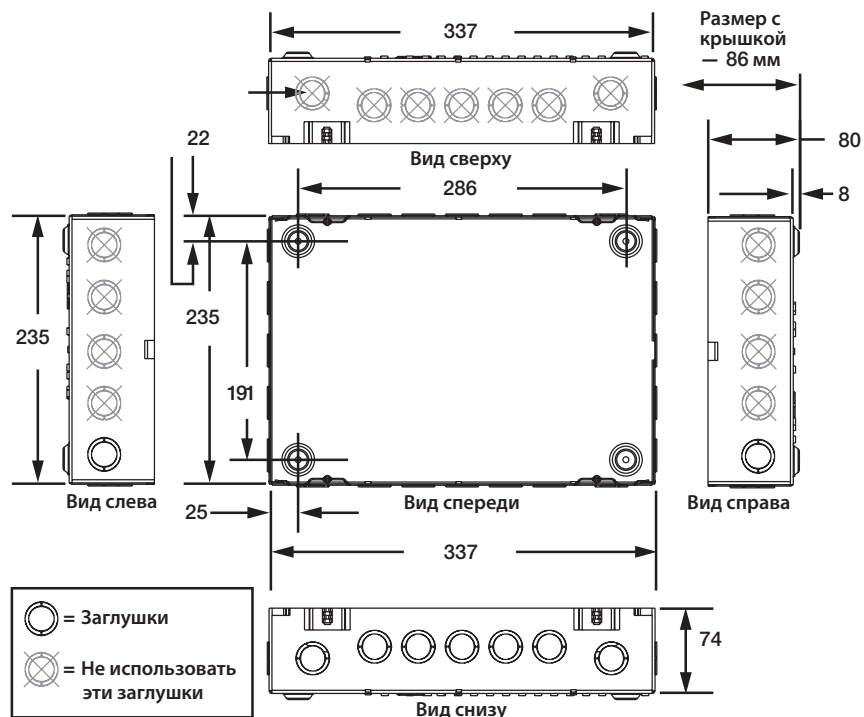

Вниманию подрядчиков!

Для прокладки электропроводки пользуйтесь имеющимися в корпусе заглушками. Сверление дополнительных отверстий в корпусе может привести к повреждению электронных компонентов внутри панели.

Монтаж

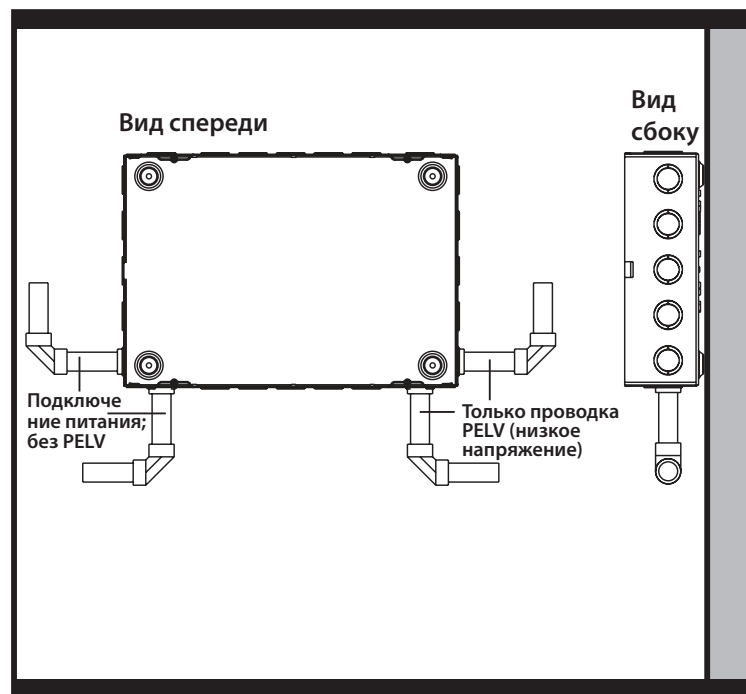

Примечания

- Только для использования внутри помещений.
- Проверьте по габаритному чертежу (см. выше) размер щита, выбивные заглушки и монтажные отверстия.
- Установка выполняется в диапазоне температуры окружающей среды от 0 до 40 °C.
- При необходимости укрепите стену согласно нормативам по массе и местным нормам.
- При установке щита следует сохранять расстояние не менее 1,8 м от сетевой проводки до акустического и электронного оборудования и его проводки.
- Lutron рекомендует пользоваться монтажными болтами 6 мм.
- Необходим зазор 32 мм с каждой стороны щита для крышки.
- Необходим зазор 63 мм между корпусами.
- Вес: 8 кг
- Не устанавливать панель внутри электрошкафа.